

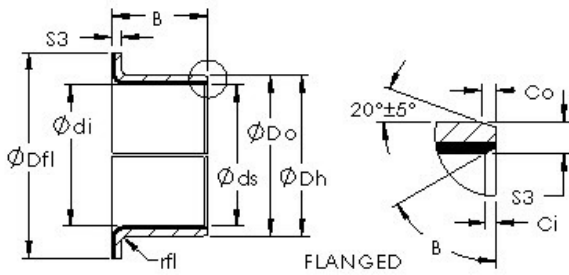

TRANSMISSIONS?BEARINGS EUROPE



AST AST40 F20165 plain bearings

Bearing No. AST40 F20165

Bore Diameter	20 mm
Outer Diameter	23 mm
Bearing Type	flanged
Shaft Dia., Nominal (d)	20.0000
Shaft Size (ds) - 20 -0.02 / -0.041	20 0.02 / 0.041
Housing Bore Dia. (Dh)	23 +0.021 / +0
Bearing Outside Diameter, Nominal(Do)	23.000
Bearing Outside Diameter Tolerance (Do tol.)	23.075 / 23.035
Bearing Bore after Mounting (di)	20.071 / 19.99
Average Clearance (Cd)	0.0610
Wall Thickness (S3)	1.505
Bearing Length, Nominal (B)	16.500
Bearing Length Tolerance (B tol.) - +0.25 / -0.25	+0.25 / 0.25
OD Chamfer Length (Co)	0.700
ID Chamfer Angle (B deg.)	30
ID Chamfer Length (Ci)	0.500
Flange Dia. (Dfl pm 0.5)	30.000
Flange Radius (rfl)	1.500
Material	Steel shell with PTFE / Polymer Fiber lining

AST40 F20165 Bearing 2D drawings and 3D CAD models